

# Bouton Haut point caps metal

# STÖCKLI

Fixation par pince

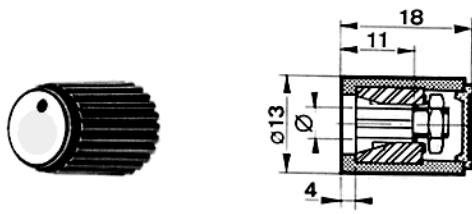

Ø	REFERENCE
3	310-13-39
4	310-13-49
5	310-13-59
6	310-13-69
1/8"	310-13-19
1/4"	310-13-29

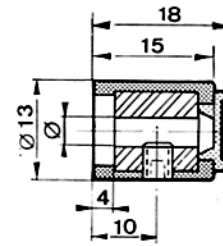

Fixation par vis

Ø	REFERENCE
3	110-13-39
4	110-13-49
6	110-13-69
1/8"	110-13-19
1/4"	110-13-29

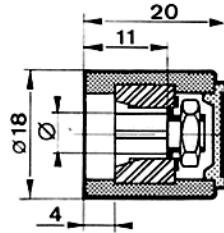
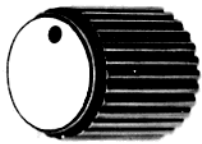

Ø	REFERENCE
3	310-14-39
4	310-14-49
5	310-14-59
6	310-14-69
1/8"	310-14-19
1/4"	310-14-29

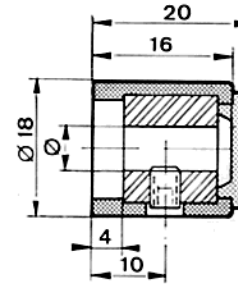

Ø	REFERENCE
3	110-14-39
4	110-14-49
6	110-14-69
1/8"	110-14-19
1/4"	110-14-29

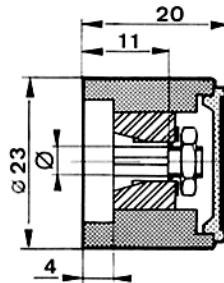
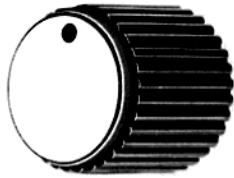

Ø	REFERENCE
3	310-15-39
4	310-15-49
5	310-15-59
6	310-15-69
1/8"	310-15-19
1/4"	310-15-29

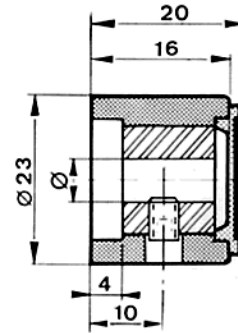

Ø	REFERENCE
4	110-15-49
6	110-15-69
1/4"	110-15-29

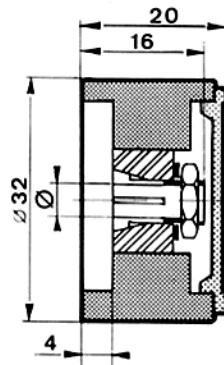
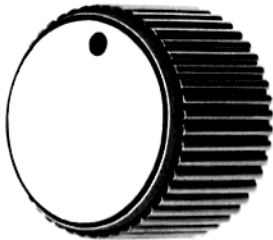

Ø	REFERENCE
4	310-16-49
5	310-16-59
6	310-16-69
1/4"	310-16-29

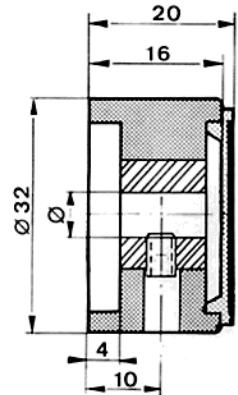

Ø	REFERENCE
4	110-16-49
6	110-16-69
8	110-16-89
10	110-16-09
1/4"	110-16-29

A vis seulement

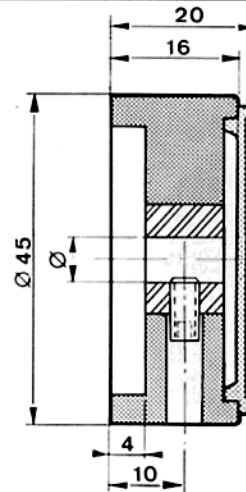
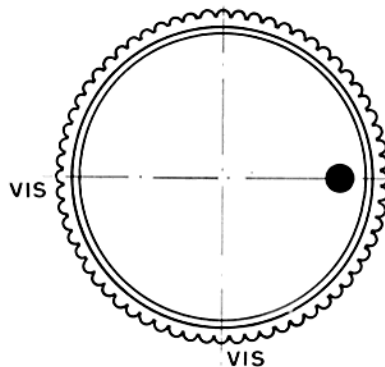
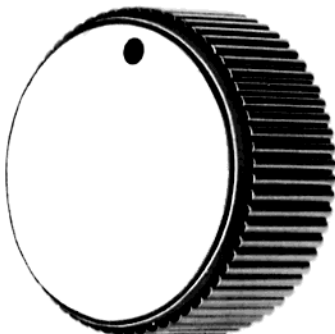

Ø	REFERENCE
4	110-17-49
6	110-17-69
8	110-17-89
10	110-17-09
1/4"	110-17-29