

COMPONENT MAINTENANCE MANUAL

Issue: 2 - 18/10/82	ROTARY SWITCH MINI A12 www.iec-monaco.com	IEC ELECTRONIQUE SJ 328
Revisions		
INCORPORATION : A 300B 09 61 289 A		
2: NATO code 1.10.2004		

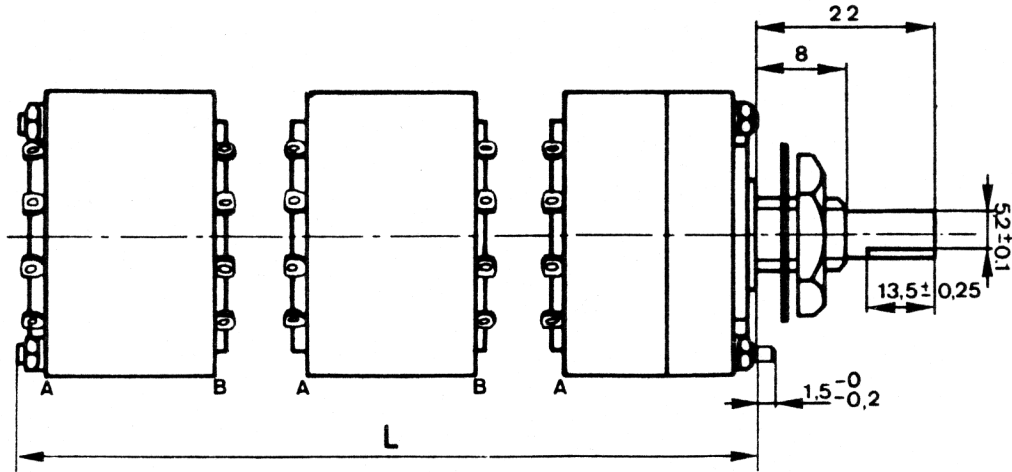

A 300B 09 61 183B L = 50

FRONT VIEW (SWITCH SIDE)

PANEL DRILLING

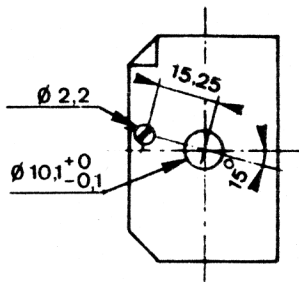

120° ROTATION LIMIT

1 - WAFER - A VIEW

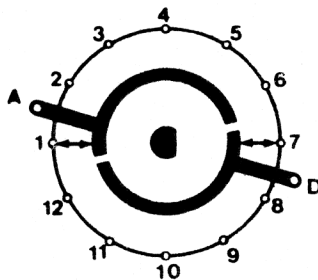

2 - WAFER - A VIEW

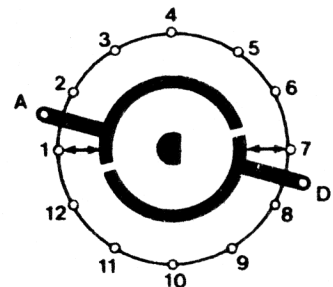

A 300B 09 61 289A L = 50

FRONT VIEW (SWITCH SIDE)

PANEL DRILLING

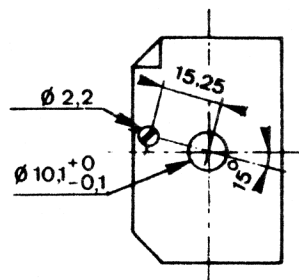

90° ROTATION LIMIT

1 - WAFER - A VIEW

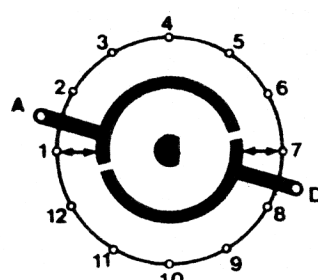

2 - WAFER - A VIEW

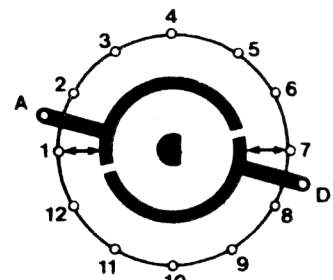

GENERAL CHARACTERISTICS

Max. operating temp. dry heat °C	+ 90
Min. operating temp. dry cold °C	- 60
Switches with solid silver contacts	
Rated voltage (Volts)	200
Rated current (Amp)	1,5
Max. breaking power (Watts)	75
Contact resistance	0.003

DIELECTRIC STRENGTH IN VOLTS D.C.

Between non shorting contacts	2500
Between contacts and pole-pieces	2000
Between contacts, pole-pieces and ground	2000
Between two adjacent contacts (Megohms)	2.10 ⁶
Between contacts and ground (Megohms)	2.10 ⁵