

## Fixation par pince

## Fixation par vis

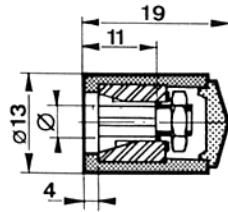

Ø	REFERENCE
3	300-03-30
4	300-03-40
5	300-03-50
6	300-03-60
1/8"	300-03-10
1/4"	300-03-20

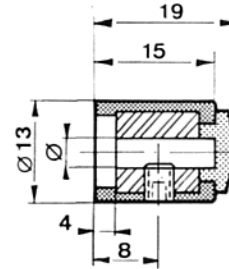

Ø	REFERENCE
3	100-03-30
4	100-03-40
6	100-03-60
1/8"	100-03-10
1/4"	100-03-20

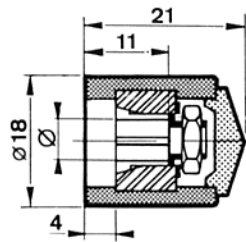
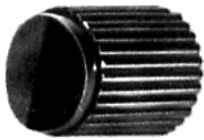

Ø	REFERENCE
3	300-04-30
4	300-04-40
5	300-04-50
6	300-04-60
1/8"	300-04-10
1/4"	300-04-20

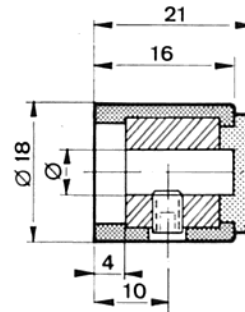

Ø	REFERENCE
3	100-04-30
4	100-04-40
6	100-04-60
1/8"	100-04-10
1/4"	100-04-20

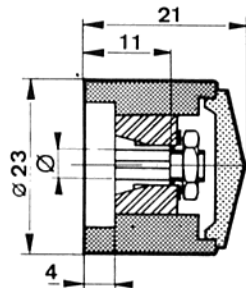
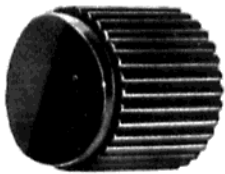

Ø	REFERENCE
3	300-05-30
4	300-05-40
5	300-05-50
6	300-05-60
1/8"	300-05-10
1/4"	300-05-20

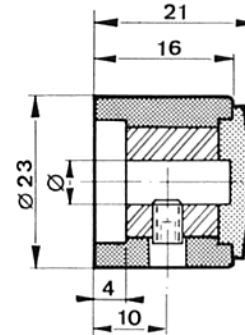

Ø	REFERENCE
4	100-05-40
6	100-05-60
1/4"	100-05-20

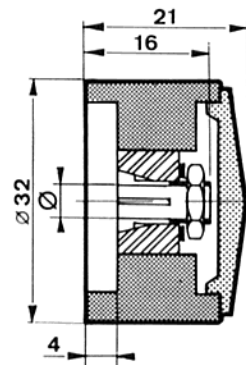
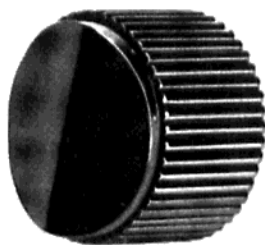

Ø	REFERENCE
4	300-06-40
5	300-06-50
6	300-06-60
1/4"	300-06-20

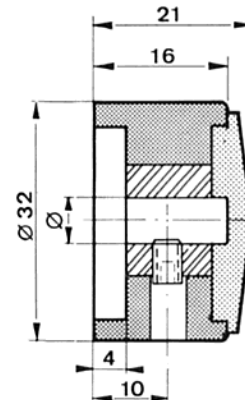

Ø	REFERENCE
4	100-06-40
6	100-06-60
8	100-06-80
10	100-06-00
1/4"	100-06-20
3/8"	100-06-90

Voir page 21 pour les astérisques

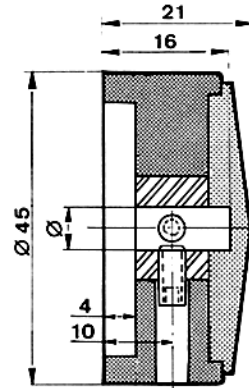
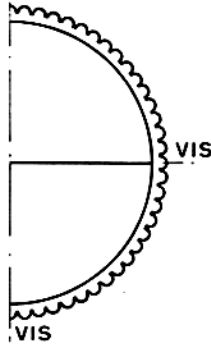
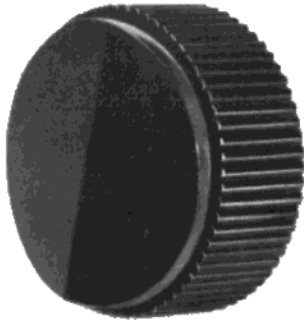

Fixation  
par vis

Ø	REFERENCE
4	100-07-40
6	100-07-60
8	100-07-80
10	100-07-00
1/4"	100-07-20
3/8"	100-07-90

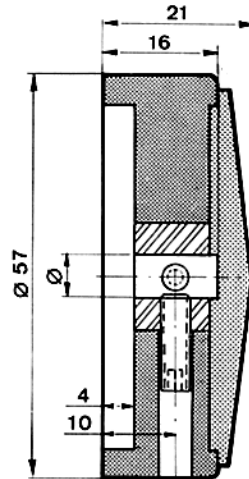
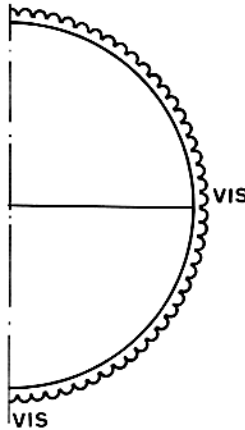

Ø	REFERENCE
6	100-08-60
8	100-08-80
10	100-08-00
1/4"	100-08-20
3/8"	100-08-90

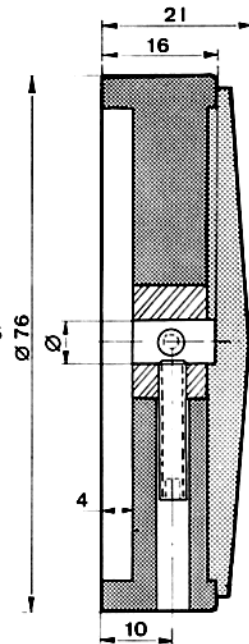
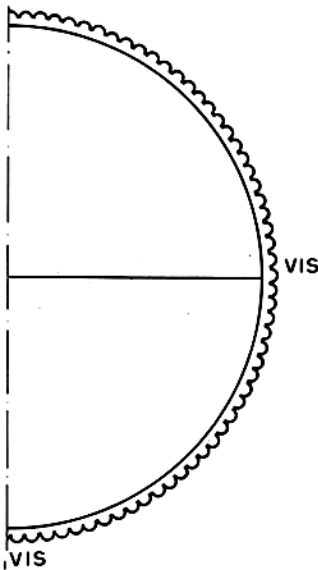

Ø	REFERENCE
6	100-09-60
8	100-09-80
10	100-09-00
1/4"	100-09-20
3/8"	100-09-20

## COLORIS SPÉCIAUX

Pour obtenir un autre coloris de la tête. Il vous suffira de remplacer le dernier chiffre de la référence choisie par l'un des numéros des coloris suivants :

Exemple : 100-03-34

pour obtenir un bouton de tête jaune.

- |              |         |
|--------------|---------|
| 1 Gris clair | 6 Bleu  |
| 2 Rouge      |         |
| 3 Orange     | 8 Gris  |
| 4 Jaune      | 9 Blanc |
| 5 Vert       |         |

## TETE

Coloris en stock **noir**

8 autres coloris sur commande



## CORPS NOIR

